

Technical Specifications

Voltage:	Solenoid	Voltage	Inrush [A]	Holding[A]
Current:	2W 50 Hz	$V_{+10\%}$ $n-20\%$	0.3	0.19
	2W 60 Hz		0.2	0.14
	3W 50 or 60 Hz		0.125	0.125
	DC		4.5W	

Electric connection: Lead wires 35 cm, 18 Awg
 Protection: IP66
 Ambient Temp: Max 60° C
 Fluid Temp: Max 80° C

Materials

Housing: Reinforced Nylon 66
 Plunger and Pole: Passivated AISI430F
 Rubber Seal: EPDM
 Encapsulate: Polyurethane

Working Pressure 2W NC

Orifice	up to 2.0
Pressure (bar)	12

Working Pressure 3W NC

Orifice	1.0	1.2	1.6
AC Pressure (bar)	16	11	6
DC Pressure (bar)	12	9	5

Working Pressure 3W NO

Orifice	1.0	1.2	1.6
Pressure (bar)	16	12	8

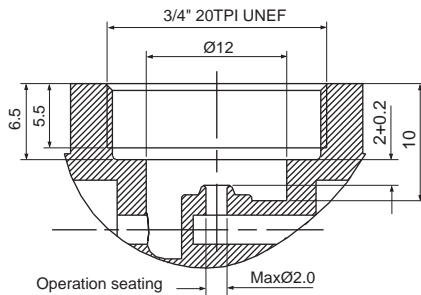

Dimensions

